



**16/86 Wrights Road Kellyville NSW**

**3**  **2**  **2** 

Positioned within a well-maintained complex in a highly convenient location, this impeccably presented multi-level townhouse delivers a refined blend of space, style and low-maintenance living. Showcasing expansive, light-filled interiors complemented by high ceilings and quality finishes throughout, the home features a superb tri-level design with basement garaging, creating a highly functional and modern layout that sets it apart.

Enjoy the ease of a connected lifestyle, ideally positioned adjacent to Kellyville Plaza, offering a vibrant selection of cafes, supermarkets and everyday essentials. With close proximity to quality schools, sporting facilities, Castle Towers and the Kellyville Metro Station, this home offers exceptional convenience for families, professionals and investors alike.

**Price** : \$1,350,000 - \$1,450,000

**View** : <https://www.guardianrealty.com.au/sale/nsw/hills/kellyville/residential/townhouse/8669589>



**Stephen Giacomelli**  
0413 360 777



**Harry Hallman**  
0413 531 789

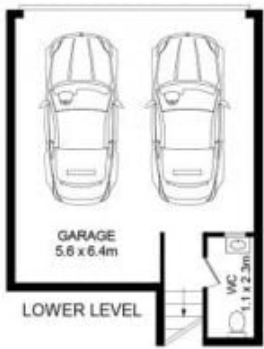

# 16/86 Wrights Road, Kellyville



**Disclaimer**  
Floor Plan measurements are approximate and are for illustrative purposes only. While we cannot doubt the floor plans accuracy, we make no guarantee, warranty or representation as to the accuracy and completeness of the floor plan

