



2A Telfer Road Castle Hill NSW

6  3  4 

Ideally situated just a brief ten-minute stroll from Castle Towers and Castle Hill metro station, this expansive residence presents a versatile floorplan tailored to accommodate multi-generational family living. Spanning over two sun-drenched levels, the flexible layout boasts multiple living zones perfect for entertaining. An oversized family and dining zone on the upper level has access to the front balcony, offering an ideal space to relax with family and friends. The well-equipped kitchen features ample bench space, plenty of storage, modern cooking appliances and views to the rear yard. Glass sliders from the meals zone open to a covered decking ideal for alfresco dining while enjoying views to the generous backyard.

Four bedrooms with built-in wardrobes, including the master suite, are set on the upper level of the home. An additional two bedrooms on the lower level are positioned in close proximity to a full bathroom, offering potential as

Price : Auction Guide \$2,100,000
Land Size : 698 sqm
View : <https://www.guardianrealty.com.au/sale/nsw/hills/castle-hill/residential/house/7935342>



Bob (Kaiji) Guan
0490 100 091



Aaron Godfrey
0422 081 888

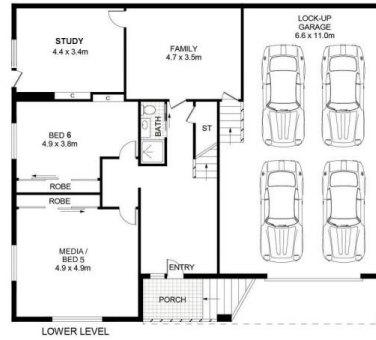

2A Telfer Road, Castle Hill

DISCLAIMER: No liability for the accuracy of details contained within our floor plans. All plans are drawn and also checked to the best of our ability, however information contained in our floor plans such as area calculations are approximate, and have not been surveyed or drawn to scale. Our floor plans are for representational purposes only and should be used as such. Do not attempt to refer to our floor plans for structural or detailed information.

