



59 Ravensbourne Way Dural NSW

4  3  2 

Boasting an uninterrupted bushland vista, this impeccably maintained residence is situated on a secluded lane within the Elouera Estate. Crafted by Denton Homes, the heart of this home is the open-plan living area on the middle level, offering both seclusion and breath taking vistas of the Dural Nature Reserve. Three bedrooms are thoughtfully positioned on their own floor, with the master retreat featuring an ensuite and a spacious double built-in wardrobe.

Designed with entertaining in mind, this home offers formal and informal living spaces, both adorned with bifold doors that lead to an entertainers paradise and a front balcony with serene bushland views. The recently refreshed granite and gas kitchen boasts top-of-the-line Ilve appliances and an expansive countertop perfect for casual dining. On the ground floor, a versatile rumpus room serves as the ideal

Land Size : 902 sqm
View : <https://www.guardianrealty.com.au/sale/nsw/hills/dural/residential/house/7740000>



Joel Green
0408 293 262



Preston Stewart
0468 848 105

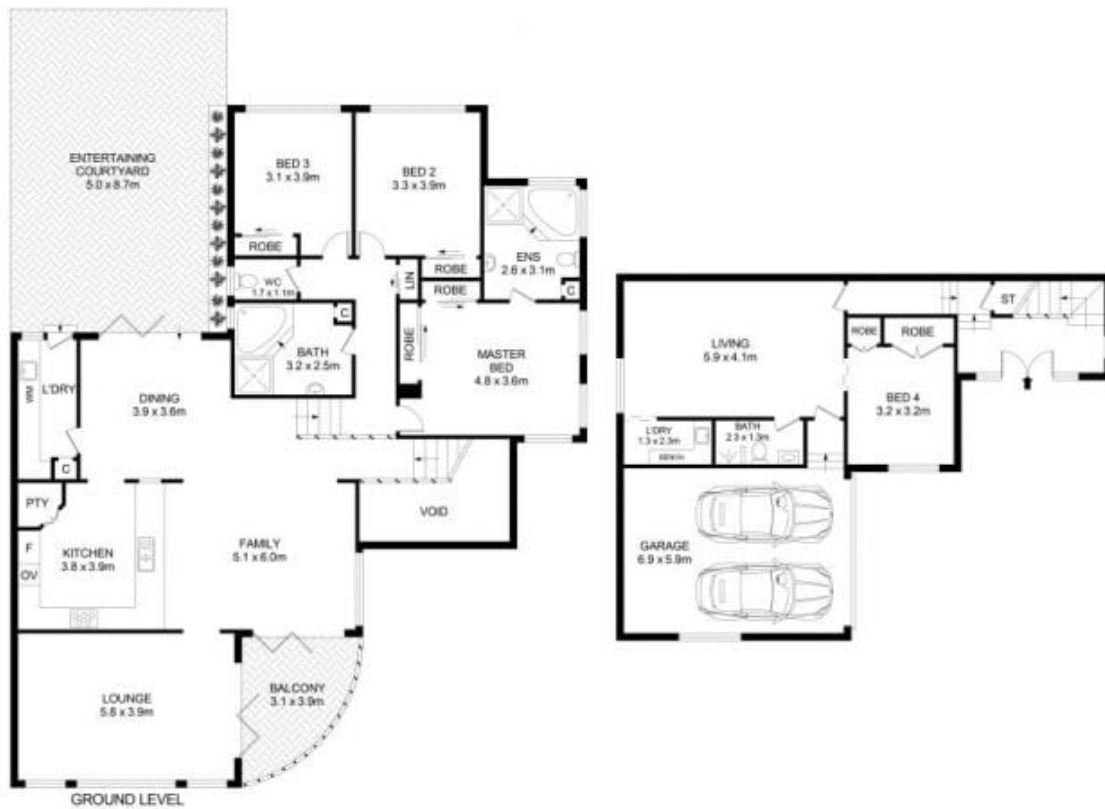

59 Ravensbourne Way, Dural



Floor Plan measurements are approximate and are for illustrative purposes only. While we cannot doubt the floor plans accuracy, we make no guarantee, warranty or representation as to the accuracy and completeness of the floor plan



guardian