



22/11 Kilbenny Street Kellyville Ridge NSW

3  2  2 

Promising an easy-care and ultra-convenient lifestyle, this generous apartment is an ideal choice for first home buyers, investors or downsizers. Freshly painted interiors include a sun-soaked living zone which flows effortlessly to the well-sized balcony, offering a space to relax and enjoy the sun. Caesarstone benchtops frame the modern kitchen which includes a gas cooktop, plenty of cupboard space and ample bench space.

Formal accommodation consists of three bedrooms with integrated storage included in each. The master bedroom enjoys the added luxury of an ensuite while a modern main bathroom with a bathtub serves the apartment. Convenience is at the doorstep with Rouse Hill Town Centre, T-way buses, childcare and Rouse Hill metro station all within walking distance.

Price : \$ 665,000
Land Size : 143 sqm
View : <https://www.guardianrealty.com.au/sale/nsw/hills/kellyville-ridge/residential/unit/7658392>



Simon Kowald
0407 433 660



Luke Browning
0431 378 280

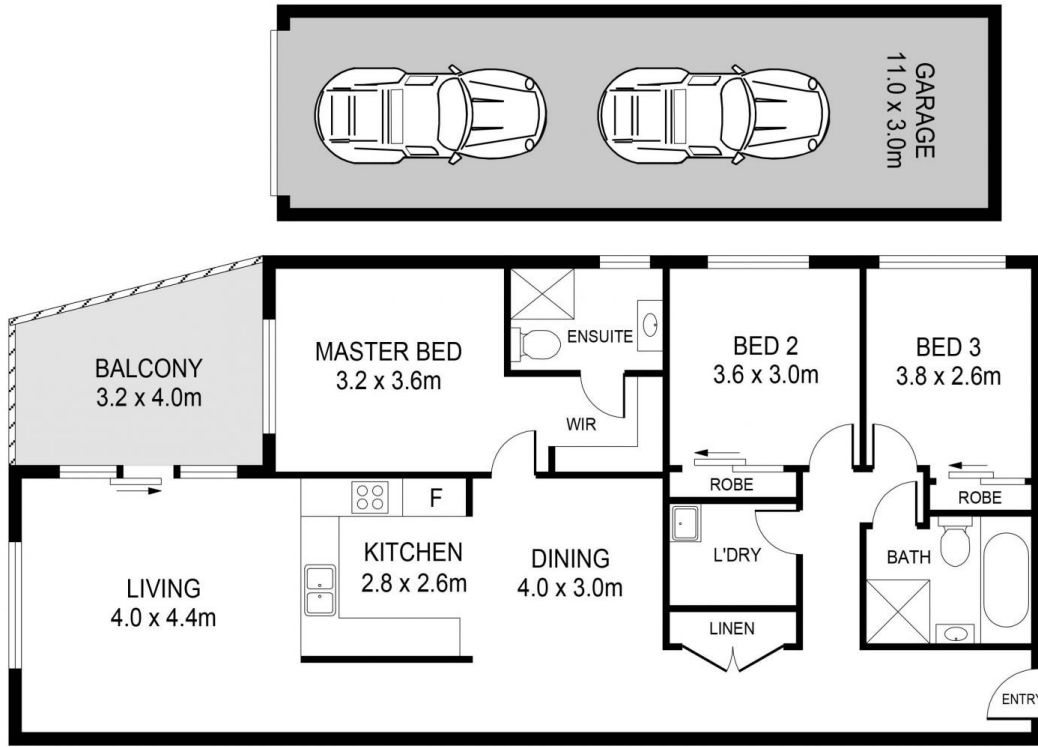

22/11 KILBENNY STREET, KELLYVILLE RIDGE

DISCLAIMER:
 PLANS SHOWN ARE FOR MARKETING PURPOSES ONLY. ALL DIMENSIONS ARE APPROXIMATE AND NOT TO SCALE. THEY ARE SUBJECT TO ERRORS AND INACCURACIES AND NO LIABILITY WILL BE ACCEPTED. INTERESTED PARTIES SHOULD MAKE THEIR OWN INQUIRIES.

