



## 6 Pilliga Circuit North Kellyville NSW

4  3  2 

Boasting grand proportions and high-quality finishes throughout, this immaculate Elandra Home is truly impressive right from its commanding street appeal. Spread over two light-filled levels, the home features multiple living spaces including an upstairs games room and a downstairs theatre room with coffered ceilings. Caesarstone benchtops and crisp cabinetry frame the gourmet kitchen which includes a butler's pantry to conceal mess, modern stainless-steel appliances and a gas cooktop. Dual glass sliders open from the formal lounge and dining zones to a covered courtyard complete with an outdoor kitchen. Bi-fold windows from the butler's pantry make alfresco entertaining easy while the grassy backyard is child and pet friendly.

The upper level of this masterpiece boasts four queen-sized bedrooms with plush carpets and integrated

**Price** : \$ 2,326,000  
**Land Size** : 600 sqm  
**View** : <https://www.guardianrealty.com.au/sale/nsw/hills/north-kellyville/residential/house/7051750>



**Mannie Vassallo**  
0415 843 110



**Stephen Giacomelli**  
0413 360 777

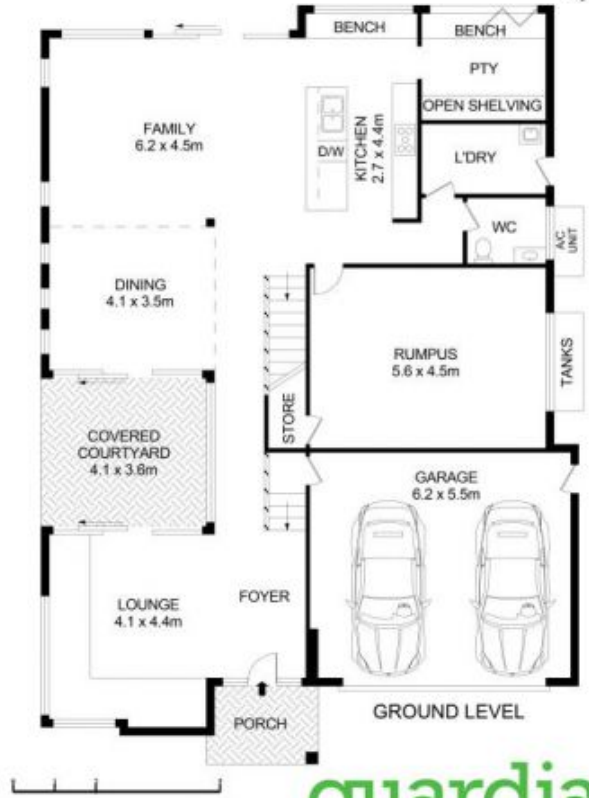

## 6 Pilliga Circuit, North Kellyville

### Disclaimer

Floor Plan measurements are approximate and are for illustrative purposes only. While we cannot doubt the floor plans accuracy, we make no guarantee, warranty or representation as to the accuracy and completeness of the floor plan.

**guardian**  
realty