



guardian



13 Bow Avenue Parklea NSW

5 2 2

Proudly standing amongst other quality family homes, this immaculate dual level residence ticks the boxes for growing families seeking a convenient lifestyle. Tiled living zones on the lower level of the home offer easy flow through to the rear alfresco and child-friendly backyard. The flexible floorplan offers multiple living zones including a media room perfect for family movie nights and a formal living space. An open family and dining zone surrounds the gourmet kitchen which boasts a large built-in pantry, modern cooking appliances and an island bench setting.

The upper level of the home features five well-sized bedrooms with timber flooring and integrated storage to four. An impressive master suite overlooks the backyard, includes a walk-in wardrobe and a neat ensuite with a double vanity. This ultra-convenient address is an easy walk to buses, close to Stanhope Village Shopping Centre

Price : \$ 1,410,000
Land Size : 572 sqm
View : <https://www.guardianrealty.com.au/sale/nsw/western-sydney/parklea/residential/house/6849367>



Aaron Godfrey
0422 081 888



Sam Schwarz
0423 731 015

<https://www.guardianrealty.com.au>

258 Old Northern Road Castle Hill NSW
02 9659 5222

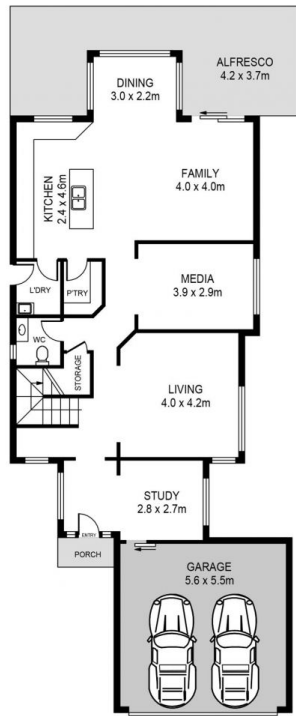

GROUND FLOOR

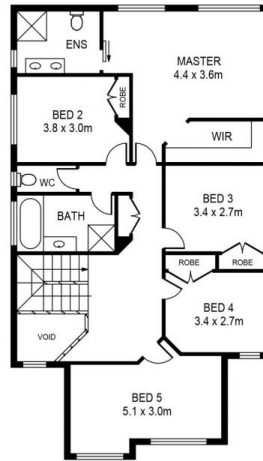

FIRST FLOOR

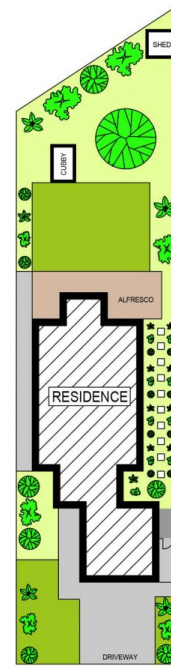

SITE PLAN



13 BOW AVENUE, PARKLEA

DISCLAIMER:

PLANS SHOWN ARE FOR MARKETING PURPOSES ONLY, ALL DIMENSIONS ARE APPROXIMATE AND NOT TO SCALE. THEY ARE SUBJECT TO ERRORS AND INACCURACIES AND NO LIABILITY WILL BE ACCEPTED. INTERESTED PARTIES SHOULD MAKE THEIR OWN INQUIRIES.