



## 24 Alessandra Drive Kellyville NSW

4  2  2 

Set across from local shops and within walking distance to buses, this easy-care duplex promises a highly-sought Hills lifestyle. Boasting modern street appeal and a flexible floorplan for family living, the ground floor opens to a lounge room on entry which flows through to a relaxed living area. Sun-soaked family and dining zones surround the neat kitchen which features a gas cooktop, ample bench space and plenty of storage. Designed to make outdoor entertaining easy, glass sliders offer easy flow to a covered alfresco area which overlooks the child-friendly backyard.

The upper-level features four well-sized and light-filled bedrooms, each with integrated storage as well as a walk in robe attached to the master. An ensuite adds a touch of privacy to the master suite while a large main bathroom serves the other three bedrooms. This address is across

**Price** : \$ 1,277,500  
**Land Size** : 308.4 sqm  
**View** : <https://www.guardianrealty.com.au/sale/nsw/hills/kellyville/residential/house/6580393>



**Luke Bavaro**  
0488 093 292



**Simon Kowald**  
0407 433 660

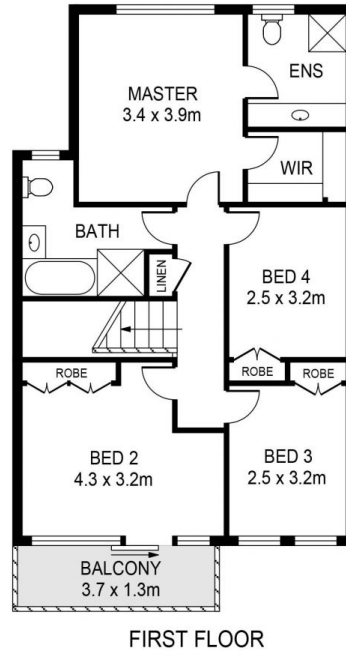
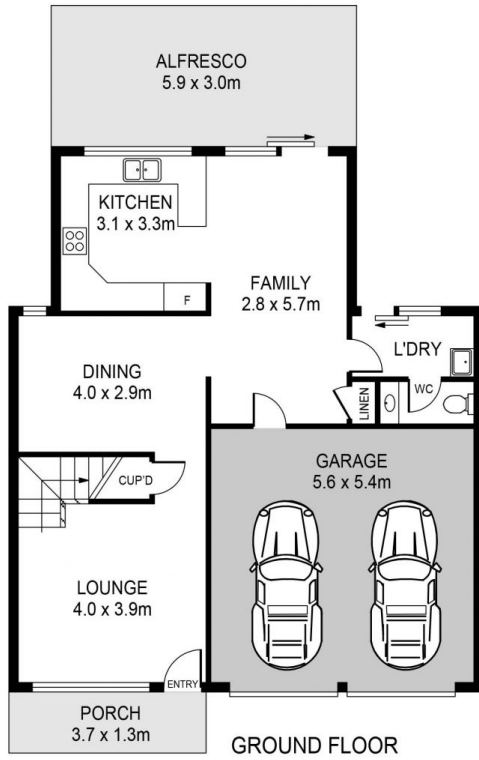

SITE PLAN



24 ALESSANDRA DRIVE, KELLYVILLE

DISCLAIMER:  
 PLANS SHOWN ARE FOR MARKETING PURPOSES ONLY, ALL DIMENSIONS ARE APPROXIMATE AND NOT TO SCALE. THEY ARE SUBJECT TO ERRORS AND INACCURACIES AND NO LIABILITY WILL BE ACCEPTED. INTERESTED PARTIES SHOULD MAKE THEIR OWN INQUIRIES.

