



23 Westminster Drive Castle Hill NSW

5  3  3 

Boasting a commanding façade in a highly-sought pocket, this dual level residence offers an abundance of living space perfect for families. Double front doors open to a formal lounge setting, exuding a relaxed feel ideal for enjoying cosy family time. Large windows allow incredible light saturation into the gourmet kitchen which features Caesarstone benchtops, a built-in pantry and plenty of cupboard space. Positioned at the rear of the home to allow for maximum warmth is a relaxed sunroom while a spacious open plan living space surrounds the kitchen area. Glass sliders open from the kitchen to a paved area overlooking the pool, perfect for entertaining guests.

Four king-sized bedrooms with integrated storage feature on the upper level of the home. The incredible master suite enjoys a chic ensuite complete with a spa bath, a large walk-in wardrobe and a balcony window which overlooks

Price : \$ 2,860,000
Land Size : 947 sqm
View : <https://www.guardianrealty.com.au/sale/nsw/hills/castle-hill/residential/house/6559160>



Daniel Toms
0448 013 566



Stephen Giacomelli
0413 360 777

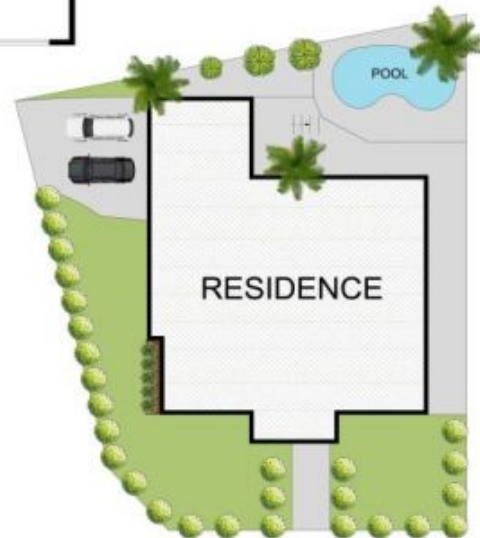
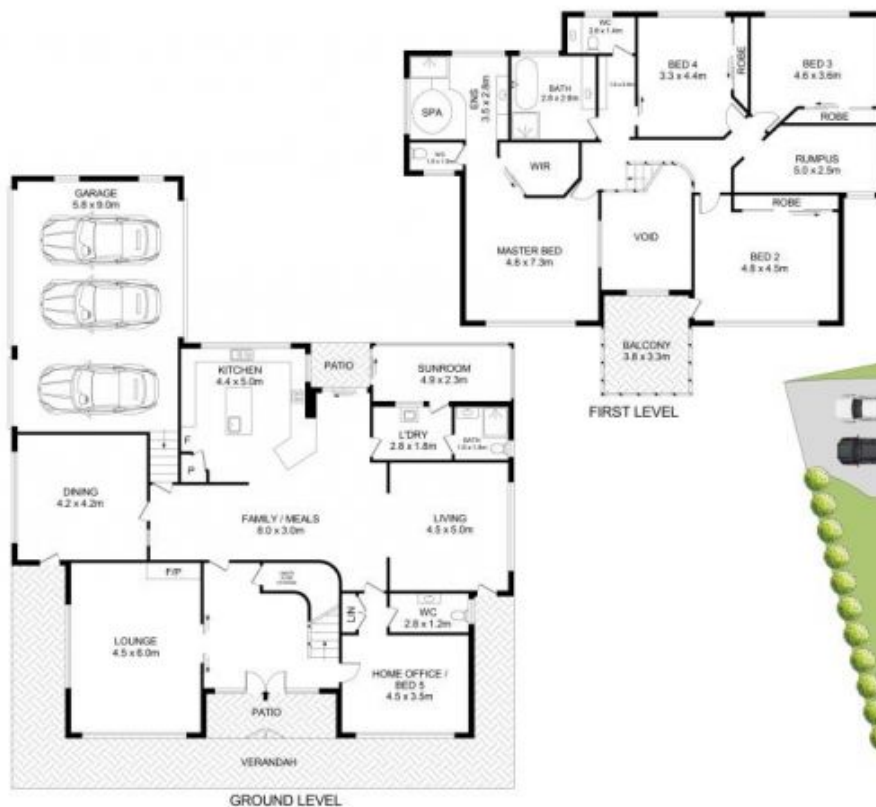

23 Westminster Drive, Castle Hill

Disclaimer

Floor Plan measurements are approximate and are for illustrative purposes only. While we cannot doubt the floor plans accuracy, we make no guarantee, warranty or representation as to the accuracy and completeness of the floor plan.



guardian
realty