

27 Myola Road Newport NSW

3  2  1 

Situated approx. 150 metres from Newport beach & village in a prime location within the highly sought after Golden Triangle. Classic beach house sits on 850m2 boasts original charm & character with well-proportioned living spaces.

View : <https://www.guardianrealty.com.au/lease/nsw/northern-beaches/newport/residential/house/6497316>

For those desiring tranquillity & convenience , this perfect home is ready for you.

- ? 3 bedrooms all with built in wardrobes
- ? 2 bathrooms 3rd toilet
- ? Updated kitchen featuring gas cooking & stainless steel appliances
- ? Streaming with natural light
- ? Timber floors boards
- ? Lock up garage plus loads off street parking
- ? An outdoor studio with toilet providing guest

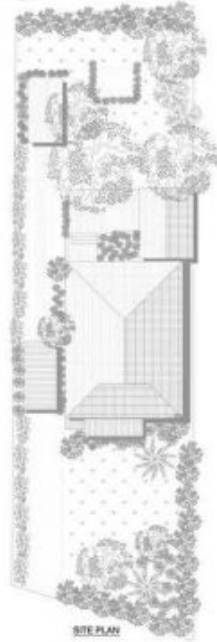

SITE PLAN



FLOOR PLAN

NEWPORT
27 MYOLA ROAD
*INTERNAL FLOOR AREA APPROX 131 m²



*PLANS DIMENSIONS INDICATIVE OF LAYOUT. DIMENSIONS ARE APPROXIMATE.
Floor plan supplied by V-mark Design Pty Ltd. This floor plan is intended for informational purposes only. Measurements are approximate and can vary. The vendor, agents and supplier will accept no liability for any errors or omissions in this plan or any other documents related to this project.