

5 Eden Circuit Pitt Town NSW

5  3  5 

Positioned on the high-side the Eden Estate on a 2,502sqm block, this semi-completed home offers opportunity to choose your colour palette and complete the build. Designed with quality inclusions in mind including high ceilings and 4 step cornices, the home is filled with smart features such as Wi-Fi garage doors and Samsung front door keyless access. The floorplan lends itself to growing families seeking plenty of living space or multi-generational living. Intended living space includes a media room, open plan meals/family area and a rumpus room. There is stair access to an oversize loft area, where you can enjoy substantial living zones as a separate area and create your own office space or teenagers retreat.

A 12 x 12m shed has been approved for the back-right corner of the block (concrete footing has been completed), an ideal place to house a caravan or boats. There is also

Price : \$ 1,665,000
Land Size : 2502 sqm
View : <https://www.guardianrealty.com.au/sale/nsw/hawkesbury/pitt-town/residential/house/5988148>

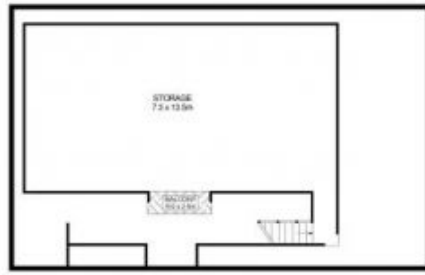

FIRST LEVEL



5 Eden Circuit, Pitt Town

Floor Plan measurements are approximate and are for illustrative purposes only. While we cannot doubt the floor plans accuracy, we make no guarantee, warranty or representation as to the accuracy and completeness of the floor plan.



guardian
realty