



2/27-29 Purser Avenue Castle Hill NSW

3  2  2 

Tucked in a quiet complex in the heart of Castle Hill, this spacious townhouse is located within walking distance to Castle Towers and the metro station. Light-filled open plan living zones boast timber flooring which leads to the generous kitchen and the outdoor covered pergola. Outdoors offers easy-care gardens with a grassy area ideal for kids to play.

Plush carpeted stairs lead to three well-sized bedrooms which are served by the main bathroom. Mirrored robes accentuate both light and space in the master bedroom, which also includes an ensuite and a ceiling fan. With schools, parks and shopping centres only moments away, the address offers easy living without sacrificing on privacy or space.

? Modern open plan design flowing to outdoor covered

Price : \$ 1,025,000

View : <https://www.guardianrealty.com.au/sale/nsw/hills/castle-hill/residential/townhouse/5978738>



Aaron Godfrey
0422 081 888



Sam Schwarz
0423 731 015

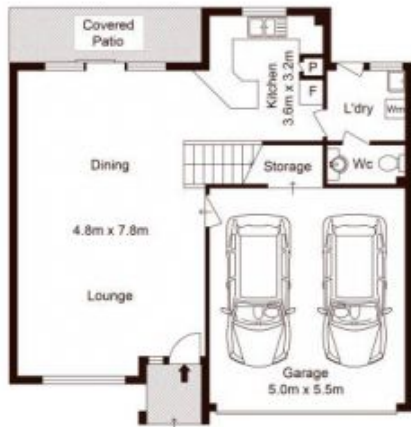

Ground Floor



First Floor



Site Plan



Scale shown in metres. All dimensions herein are approximate and gathered from sources believed to be reliable. Whilst every effort is made for the accuracy of our floor plans, interested parties should rely on their own inquiries. Floor Plan by Xorix Media

Unit 2/27-29, Purser Avenue, Castle Hill



guardian
realty