

### 33 Carmelita Circuit Rouse Hill NSW

5  2  3 

Beyond a welcoming façade, this home reveals a thoughtfully updated interior dedicated to modern family comfort. Living areas are laid out around a covered alfresco and 9m saltwater pool, putting relaxed entertaining at your fingertips. A Balinese styled cabana adds a resort feel while raised garden beds bring a calming green touch to the outdoor areas. The formal lounge room is separated from the open living area by a stone-topped kitchen. With a gas cooktop, island seating and flow to the alfresco, it's an entertainer's dream.

In the master bedroom a recessed bedhead wall adds definition and there is a walk-in wardrobe and ensuite with walk-in shower. Work from home in the office with floor-to-wall joinery and a dual desk. Side access to a carport provides secure space for a tradie, caravan or boat. Located an easy walk to Rouse Hill Public School, Rouse

**Price** : \$ 1,315,000  
**Land Size** : 731 sqm  
**View** : <https://www.guardianrealty.com.au/sale/nsw/hills/rouse-hill/residential/house/5802669>

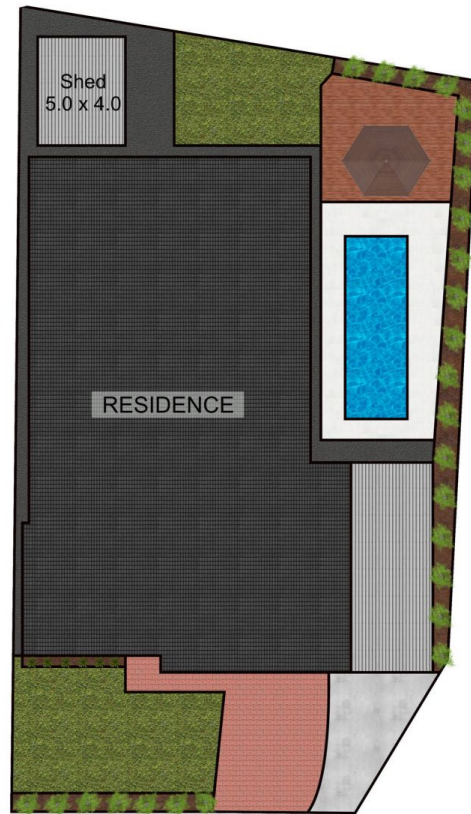
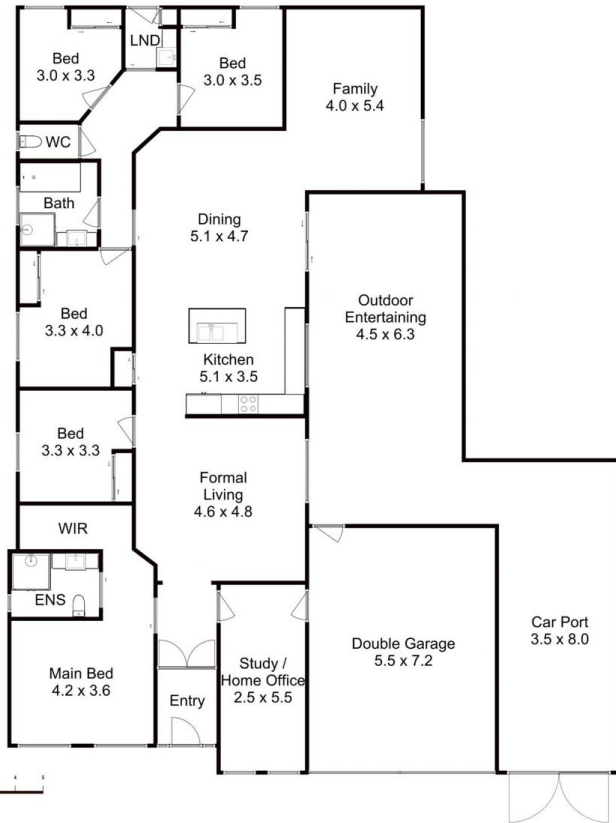

Scale shown in metres. All dimensions herein are approximate and gathered from sources believed to be reliable. Whilst every effort is made for the accuracy of our floor plans, interested parties should rely on their own inquiries.

33 Carmelita Cct, Rouse Hill

guardian  
realty