

## 82 Grima Street Schofields NSW

4  2  2 

Style and flow set this home apart for families seeking a haven in an enviable location. Timber-toned floors harmonise with clean lines and a neutral palette. Sky lit living areas are open and bright for a wonderful sense of togetherness. The media room is ideal as a kids' lounge while maintaining good connection to the rest of the home. A waterfall edge stone island articulates the striking kitchen that has a walk-in pantry, gas cooktop and stainless steel appliances.

Generously appointed bedrooms are laid out around the living zones and three have built-in wardrobes. Louvre windows enhance the light and fresh air for the master bedroom, which comes with an ensuite and custom fitted walk-in wardrobe. Families will love the walkability to Schofields station, shops and Glory Park as well as St Joseph's Primary School and St John Paul II Catholic

**Price** : \$ 1,015,000

**Land Size** : 517 sqm

**View** : <https://www.guardianrealty.com.au/sale/nsw/western-sydney/schofields/residential/house/5355975>

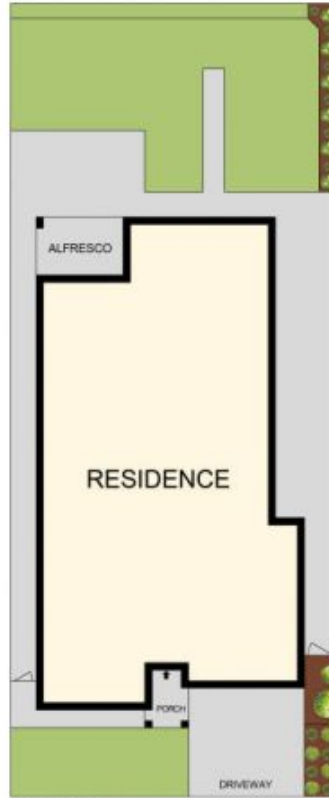

## 82 Grima Street, Schofields

### Disclaimer

Floor Plan measurements are approximate and are for illustrative purposes only. While we cannot doubt the floor plans accuracy, we make no guarantee, warranty or representation as to the accuracy and completeness of the floor plan

