



## 10 Murray Farm Road Carlingford NSW

5 3 2

This suburb-best family property, offered to the market for the first time in 40 years, has endless untapped potential. The 3,024sqm landholding comes with approval for development into three separate titles, with two lots at the rear on prestigious Pine Tree Drive. Each title has potential for dual-occupancy dwellings.

**Land Size** : 3024 sqm  
**View** : <https://www.guardianrealty.com.au/sale/nsw/northern-suburbs/carlingford/residential/house/5320190>

The 31-metre double frontage onto Murray Farm Rd offers further subdivision (STCA) and development opportunities, including a 90-100 place Child Care Centre (subject to consent from City of Parramatta Council). Current zoning also allows for Boarding Houses, Dwelling Houses and Group Homes (STCA).

This exceptional property could also be the ultimate lifestyle estate, with multiple dwellings for multi-generational living. The existing architect-designed five-bedroom home, surrounded by expansive lawns, fronts



**Stephen Giacomelli**  
0413 360 777



**Daniel Toms**  
0448 013 566



Lower Level

Upper Level

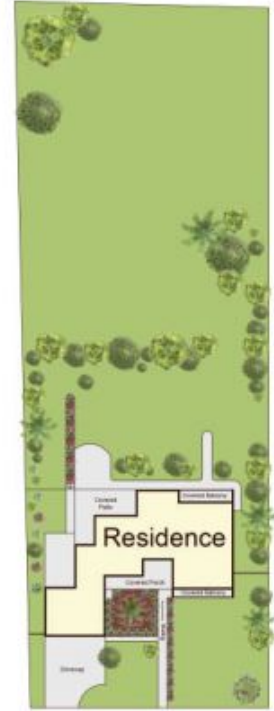

Site Plan



Scale shown in metres. All dimensions herein are approximate and gathered from sources believed to be reliable. Whilst every effort is made for the accuracy of our floor plans, interested parties should rely on their own inquiries. Floor Plan by Xorix Media.

10 Murray Farm Road, Carlingford

guardian  
realty